

KEY FEATURES

- Excellent, low insertion loss
- High isolation and reliability
- Specifically designed for communications applications, military applications, cellular and wireless markets etc.

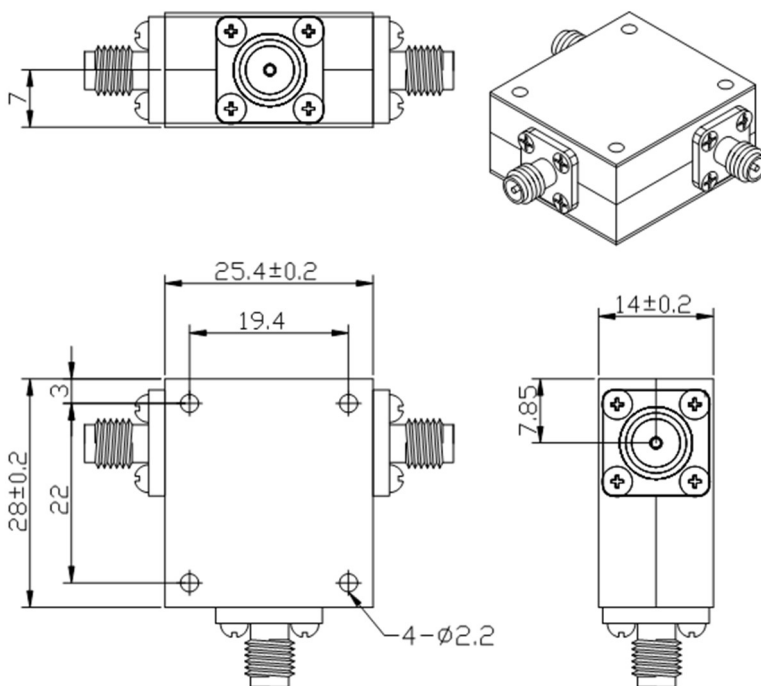
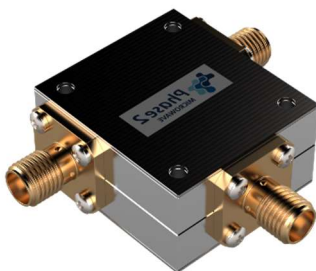

Key Specification

Model	006472
Nominal Impedance	50ohm
Frequency Range	2700-6200 MHz
Insertion Loss	≤ 0.8 dB
Isolation	≥ 16 dB
Forward Power	100 Watts CW
V.S.W.R	≤ 1.25

Environmental

Temperature Range	-10°C ~ +60°C
-------------------	---------------

Mechanical

Housing	Aluminum
Connector	Gold plated brass or Tri-metal plated brass
Female Contact	Gold plated beryllium brass
RoHs	Compliant
Dimension	25.4×28×14 mm

Note: All information is correct at date of issue. Specifications are subject to change without notice

Issued: 16/07/20

Revision: 01